

OPERATION AND MAINTENANCE

Thermal oil vapors leaking from a system can be highly flammable.

Any system leak should be repaired immediately.

Do not insulate the pump or system piping with porous flammable insulation. Fluid may wick, decompose and spontaneously ignite.

Ideal mechanical seal life is 20,000 hours.

Reduced seal life may be experienced from extreme conditions.

Recommended spare parts and service parts to rebuild the HTO-80 are:

At disassembly, check the impeller and other wear items for unusual wear. Replace if necessary.

When servicing the pump, care should be taken that the pump has cooled to a sufficient temperature to permit disassembly. The product should be drained from the pump housing and disposed in accordance with the fluid manufacturer's recommendations. Operating personnel should be warned to exercise care and utilize eye and skin protection when servicing the pump.

PART NO.	DESCRIPTION	QTY.
29166	DRIVE SLEEVE	1
25662	GASKET	1
29158	ISOLATOR	2
29167	LIP SEAL	1
29168	SEAL ASSEMBLY	1
29165	GASKET	3
29230	O-RING	1

HTO PUMP CROSS-SECTION AND DETAIL

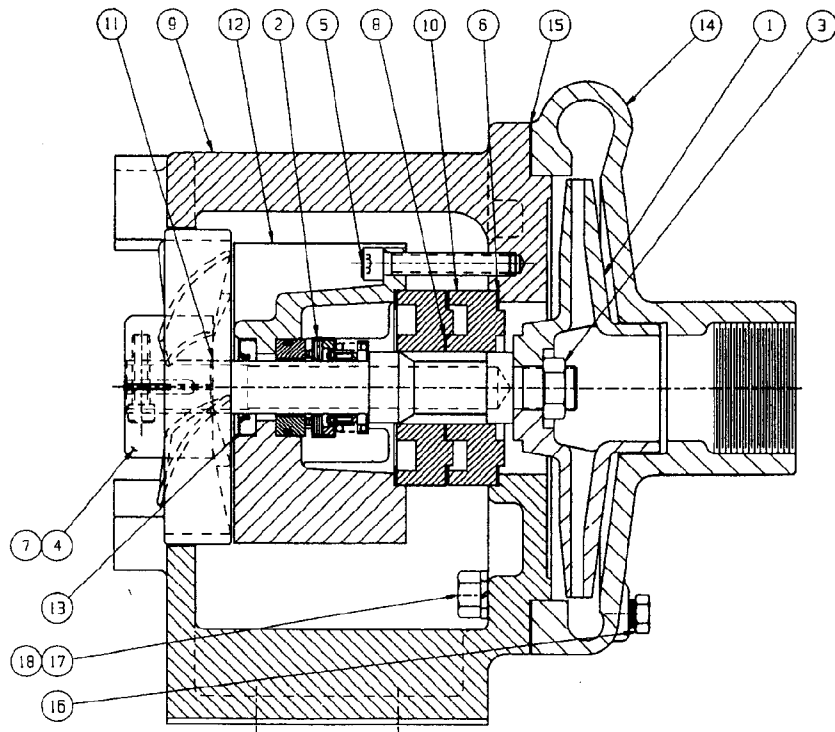

DET.	DESCRIPTION
1	IMPELLER - CAST IRON
2	SEAL ASSEMBLY
3	HEX JAM NUT - S.S.
4	COOLING FAN CLAMP - ALUMINUM
5	CAPSCREW
6	GASKET
7	CAPSCREW
8	O-RING - VITON
9	ADAPTOR - DUCTILE IRON
10	ISOLATOR - CARBON GRAPHITE
11	DRIVE SLEEVE - STAINLESS STEEL
12	SEAL HOUSING - DUCTILE IRON
13	LIP SEAL - VITON
14	HOUSING - DUCTILE IRON
15	GASKET
16	PIPE PLUG S.S.
17	LOCKWASHER S.S.
18	CAPSCREW CPS