

A heavy duty pedestal pump can be driven by standard electric or hydraulic motors, gasoline or diesel engines, pulleys, belts or clutch drives.

Open adaptor construction provides adequate drainage to keep liquids from damaging drivers. A heavy duty ball bearing pedestal for longer life. Standard or severe service seals available using Viton and stainless steel parts.

Tested pumps are available with or without drivers. Various impeller diameters are available to suit different head/flow requirements.

PUMP SPECIFICATIONS

Suction and Discharge ..	2 1/2" x 2" NPT
Housing	Bronze or Cast Iron
Impeller	Bronze or Cast Iron (Open)
Shaft	1" Shaft with Stainless Steel sleeve
Fasteners	Stainless Steel or Bronze
Seal	Standard carbon/ceramic Viton Special seal material available (consult factory)
Rotation	Right hand, left hand, Reversible

SERIES 200

2 1/2" x 2" CENTRIFUGAL PUMP

PEDESTAL PUMP
FOR BELT OR
DIRECT DRIVE
UP TO 320 GPM
Up to 110 Feet Head

AVAILABLE IN:
CAST IRON
BRONZE
STAINLESS STEEL
FASTENERS



MP PUMPS, INC.

34800 BENNETT • FRASER, MI 48026-1686
(586) 293-8240 • FAX (586) 293-8469
(800) 563-8006 • www.mppumps.com

SERIES 200

2 1/2" x 2"

**STRAIGHT CENTRIFUGAL
PEDESTAL MOUNT
BELT OR DIRECT DRIVE**

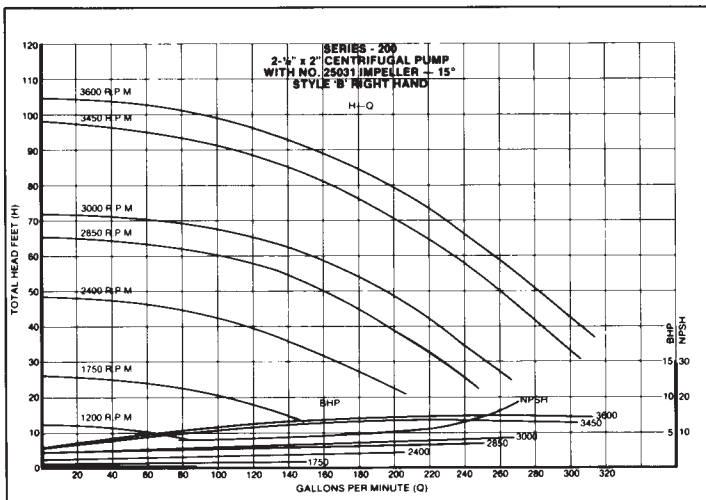
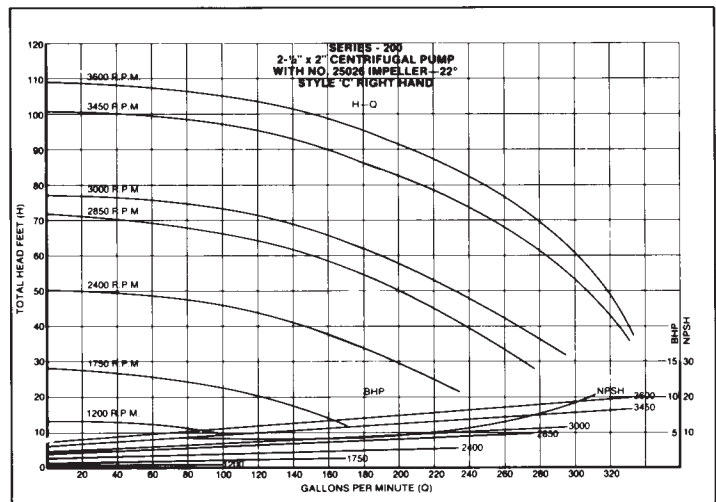
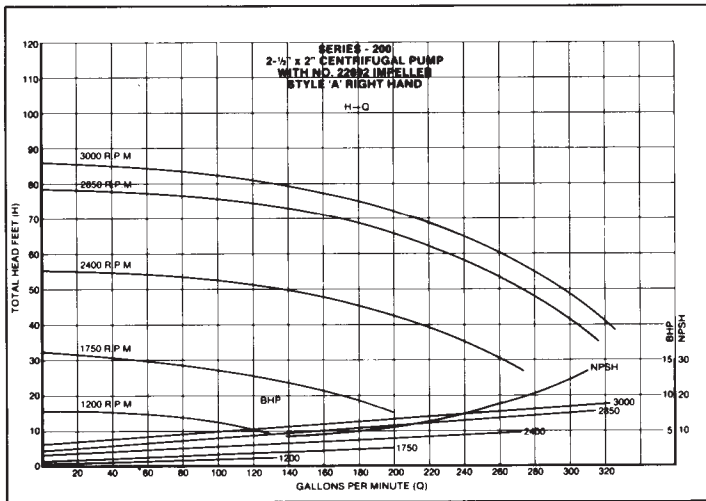
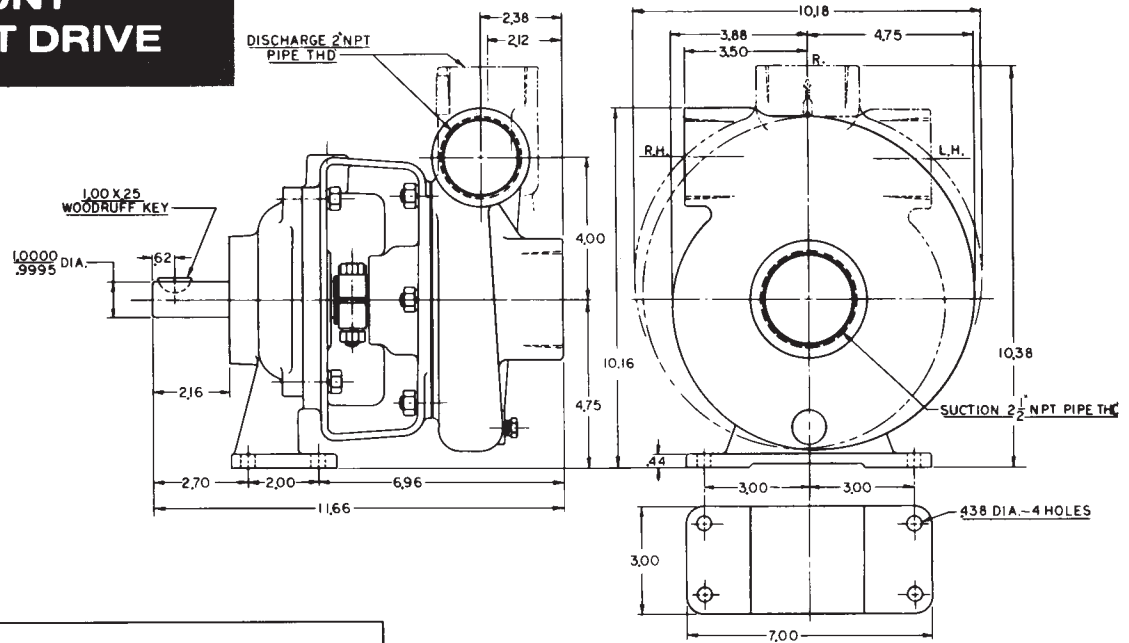

Note: Curves shown are for right hand pump models only.

Consult factory for performance on left hand or reversible pumps.



MP PUMPS, INC.

34800 BENNETT • FRASER, MI 48026-1686
(586) 293-8240 • FAX (586) 293-8469
(800) 563-8006 • www.mppumps.com